



SMAP
2024
Lille

SPONSORING KIT



SEPTEMBER 16-19
2024
LILLE / FRANCE



SMAP 2024

INTRODUCTION



SMAP
2024
Lille

On behalf of the French Society of Mass Spectrometry (SFSM) and the French Proteomics Society (FPS), we are pleased to announce that the next conference on Mass Spectrometry and Proteomic Analysis (SMAP) will be held in Lille at the Grand Palais from September 16 to 19, 2024. **SMAP 2024** will gather more than 400 participants. Lille's central location between Paris, Brussels, and London makes it a strategic place for a congress.

SMAP 2024 offers a unique opportunity for scientists working in the field of analytical chemistry, including mass spectrometry, chromatography, -omics sciences, data analysis, and more, to communicate and discuss their work.

This event provides a platform to enhance your company's exposure, increase brand awareness in the market, and connect with leading scientists.

We are confident that you will want to join us at this scientific event, which will serve as a reunion for the community of scientists working in mass spectrometry and proteomics in 2024. You will also have the opportunity to actively participate and make your presence stand out at the congress.

Please consider the participation options, and even if you are unable to attend the meeting, your company can still include advertisements in the participant's kits.

You will find a presentation of the different sponsorship opportunities herewith. The booking platform will arrive soon.

We thank you again for your time and hope to hear from you soon.

See you in September 2024 in Lille.

Sincerely,

The Organizing Committee

Delphine Pflieger,
President of the FPS

Joelle Vinh,
President of the SFSM

Some 2019 numbers



352 attendees incl:

215 Senior registrations

137 Junior registrations

22 Sponsors

Key numbers 2024

- 10 plenary sessions
- 14 parallel sessions between mass spectrometry and proteomics
- 5 poster sessions
- Up to 6 lunch seminars for company



What is new in 2024 ?

For the first time since 2019, and after an "Analytics" version in 2022, **SMAP** returns to its original formula, **bringing together French mass spectrometry and proteomics companies**. In order to offer you a scientific emulation linking technology, analytical strategies and the analyte, SMAP 2024 will welcome you to **Lille**, the crossroads of Europe enabling national and international outreach.

We'll be welcoming you the day after Lille's famous flea market "Grande Braderie de Lille" (September 16-19, 2024), in the Grand Palais.

This meeting is an opportunity for companies to present their new technologies, but also to **raise awareness** in the proteomics community of their possible uses and applications.

SCIENTIFIC COMMITTEE

SMAP 2024 will be supported by a Scientific Advisory Board of 15 members from the best-known French scientists in their fields, drawn from all over France, but also from other border countries like Belgium and Italy, with gender and thematic parity between mass spectrometry instrumentation and protein analysis.

- **Isabelle Fournier**, PRISM, Université de Lille - France
- **Etienne Coyaud**, PRISM, Université de Lille - France
- **Isabelle Compagnon**, ILM, Université Claude Bernard Lyon - France
- **Giovanni Chiappetta**, ESPCI Paris - France
- **Delphine Pflieger**, EDyP, Grenoble - France
- **Hélène Lavanant**, COBRA, Université Rouen Normandie - France
- **Laurence Charles**, IRC, Université d'Aix-Marseille - France
- **Lennart Martens**, VIB, Université de Ghent - Belgique
- **Pascal Gerbaux**, Université de Mons - Belgique
- **David Touboul**, ICSM, Paris - France
- **Julien Marcoux**, IIPBS, Toulouse - France
- **Emilie-Fleur Gautier**, IC, Paris - France
- **Emmanuelle Com**, Protim, Rennes - France
- **Gianluca Picariello**, ISA, Avellino - Italie
- **Tim Van Den Bossche**, VIB, Université de Ghent - Belgique

SMAP 2024

LOCAL ORGANIZING COMMITTEE



SMAP
2024
Lille

The Local Organizing Committee counts **28 members** leading by **Professor Isabelle Fournier**, representative of the regional diversity of Haut-de-France:

- 15 members present on the Cité Scientifique of Lille University, including representatives from FPS and SFSM (PRISM-U1192, MSAP, UGSF, BioEcoAgro)
- 8 members from the Faculty of Medicine and/or Pharmacy (RID-AGE Inserm U1167, ULR GRITA, CHU Lille)
- 1 member from a local start-up (APTEEUS)
- 3 members from the University of Artois
- 1 member from University de Picardie Jules Verne

ORGANIZING COMMITTEE

- | | |
|---|--|
| <ul style="list-style-type: none">• Isabelle Fournier, PRISM Inserm U1192• Michel Salzet, PRISM Inserm U1192• Julien Franck, PRISM Inserm U1192• Maxence Wisztorski, PRISM Inserm U1192• Etienne Coyaud, PRISM Inserm U1192• Marie Duhamel, PRISM Inserm U1192• Tristan Cardon, PRISM Inserm U1192• Antonella Raffo-Romero, PRISM Inserm U1192• Zoltan Takats, PRISM Inserm U1192• Blandine Chazarin, PRISM Inserm U1192• Christophe Flahaut, BioEcoAgro• Fabrice Bray, MSAP• Stéphanie Flament, MSAP• Christian Rolando, MSAP• Yann Guerardel, UGSF | <ul style="list-style-type: none">• Jean-François Goossens, Pharma ULR GRITA• Mostafa Kouach, Pharma ULR GRITA• Amandine Descat, Pharma ULR GRITA• Sophie Duban, Univ. Artois• Bodale Djobo, CBP CHU Lille• Luc Humbert, CBP CHU Lille• Anne-Frédérique Dessein, CBP CHU Lille• Paulo Marcelo, UPJV• Michael Howsam, U1167 Inserm Médecine• Frédéric Tessier, U1167 Inserm Médecine• Nadjla Hammoudi, APTEEUS• Johan Hachani, Univ. Artois• Christophe Landry, Univ. Artois |
|---|--|



SMAP 2024 will bring together no fewer than **20 topics** ranging from mass spectrometry instrumentation, proteomics methodology and small molecule identification by MS, to a societal and mentoring session for ECRs, as well as junior presentations dedicated to students.

TOPICS

AI and Bioinformatics
Spatial OMICs and MS Imaging
Top-down and Structural analysis - PTM
Proteogenomics and metaproteomics
New topics in OMICs
Plant and Food OMICS
Quantitative Proteomics in Systems Biology
Quantification and Small molecules
Ion mobility spectrometry
Instrumental development

Environmental analysis
Complex mixtures - polymers - microplastics
Forensic and cultural heritage
Health and biological sciences I
Data representation - molecular network
Health and biological sciences II
MS-Based Metabolomics
Women in MS and ECR
Youth Club FPS
Youth Club SFSM



The ECR Networking Night will be an entertaining evening for early career researchers. This event will be a fantastic opportunity for early career researchers to network with peers and mentors from all over fields. And for each company, you may just find the next superstar to hire!

Early Career Researcher (ECR) is a community for researchers in the first 10 years of their professional work experience that was created to support the specific needs of ECRs in research in our case in the field of mass spectrometry and in proteomic.

ECR EVENT

SMAP2024 is an opportunity to showcase the **talents of tomorrow**. Through a program defining the vision of tomorrow in mass spectrometry and proteomics, we invite the young club community and the wider **Early Career Researcher** (ECR) community to join us. SMAP2024 will feature a session dedicated to the life of future researchers, and if sponsors allow, we would like to organize an ECR event bringing together private companies, start-ups, local partners and French and international laboratory heads.

SMAP 2024

SMAP SPONSORING KITS



SMAP
2024
Lille

*Prices valid until January 31

| | Diamond | Platinum | Gold | Silver | Bronze |
|---|--|--|--|--|--|
|  EARLY BIRDS DISCOUNTS* | 16,200 € 18,000 € excl. VAT (VAT 20%) | 12,600 € 14,000 € excl. VAT (VAT 20%) | 7,200 € 8,000 € excl. VAT (VAT 20%) | 4,500 € 5,000 € excl. VAT (VAT 20%) | 2,500 € excl. VAT (VAT 20%) |
| Stand surface (including furniture)* | 25m2 <i>furniture on demand</i> | 15m2 <i>2 tables + 4 chairs</i> | 9m2 <i>1 table + 2 chairs</i> | 6m2 <i>1 table + 2 chairs</i> | 3m2 <i>1 table + 2 chairs</i> |
| Transferable full pass (gala dinner included) | 5 | 4 | 3 | 2 | |
| Your logo on the e-programme | ✓ | ✓ | ✓ | ✓ | ✓ |
| Your logo on the website | ✓ | ✓ | ✓ | ✓ | ✓ |
| 5 min talk at the end of a plenary session | ✓ | ✓ | ✓ | | |
| Insertion of your flyer in the conference bag | ✓ | ✓ | ✓ | | |
| Sending of an emailing campaign to the attendees | ✓ | ✓ | | | |
| Seminar (45mn) during lunch break (lunchboxes to be provided) | ✓ | ✓ | | | |
| Your logo on the conference bag (to be provided) | ✓ | | | | |

SMAP 2024

SMAP SPONSORING OPTIONS



Conference sponsoring options

- **Additional transferable full pass - 800€ (excl. 20% VAT)**
- **Seminar (45mn) during lunch break - lunchboxes to be provided - 2,000€ (excl. 20% VAT)**
- **5 min talk in plenary session – 1,500€ (excl. 20% VAT) , special fee for Silver sponsors : 750€ (excl. 20% VAT)**
- **Lanyards sponsoring (to be provided) - 5,000€ (excl. 20% VAT)**
- **Goodies sponsoring (to be provided) - 1,500€ (excl. 20% VAT)**
- **Insertion of your flyer in the conference bag - 1,000€ (excl. 20% VAT)**
- **License to access our lead capture app (available on Apple and Android stores) - 500€ (excl. 20% VAT)**
- **Sponsoring of a coffee break – according to quotation**
- **Sponsoring of the welcome party – according to quotation**
- **Sponsoring of the Gala dinner – photobooth for instance - according to quotation**

Other partnerships

- For any other sponsoring opportunities such as prizes for the best poster or oral presentation of your choice.
- For sponsoring of the ECR event organized between private companies and young researcher, in order to improve the contact of young researcher with future recruiters.
- **Please contact us at sponsors-smap2024@inviteo.fr**

Our commitment : to make you the core support of the event !

Be a partner of SMAP 2024 and increase your visibility through effective and tailored promotion and communication channels.

Be part of this outstanding event. Join us !





Exhibition area

Exhibitors taking part in **SMAP2024** at Lille Grand Palais will be able to occupy no less than **1,400sqm** of space at their disposal. An initial layout plan allows us to preview the possibilities, and all proposals will be studied. In addition, when you register, you'll have the opportunity to choose your layout.

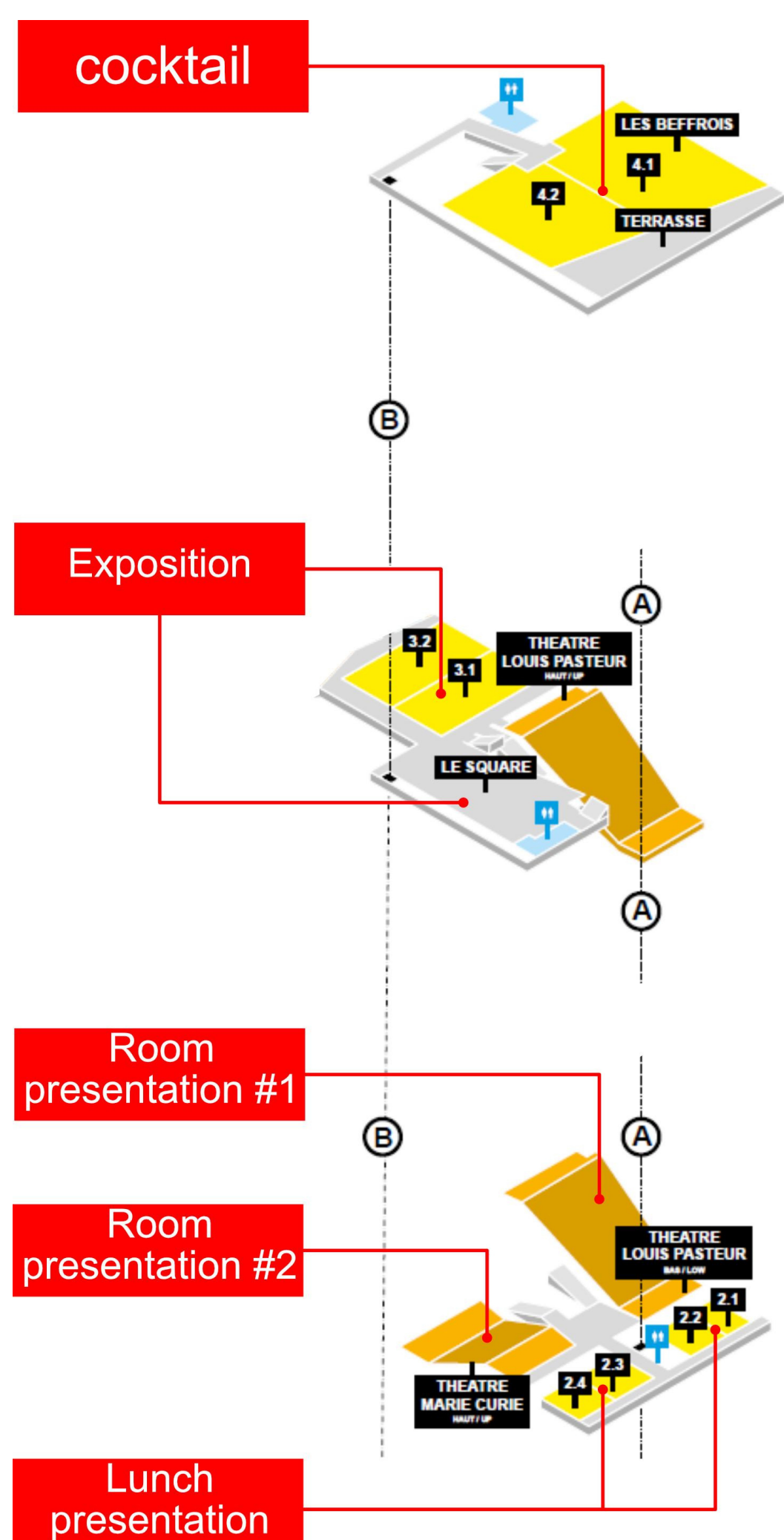

4

3 HAUT
UP

3

3 BAS
LOW

2

expected exhibition plan

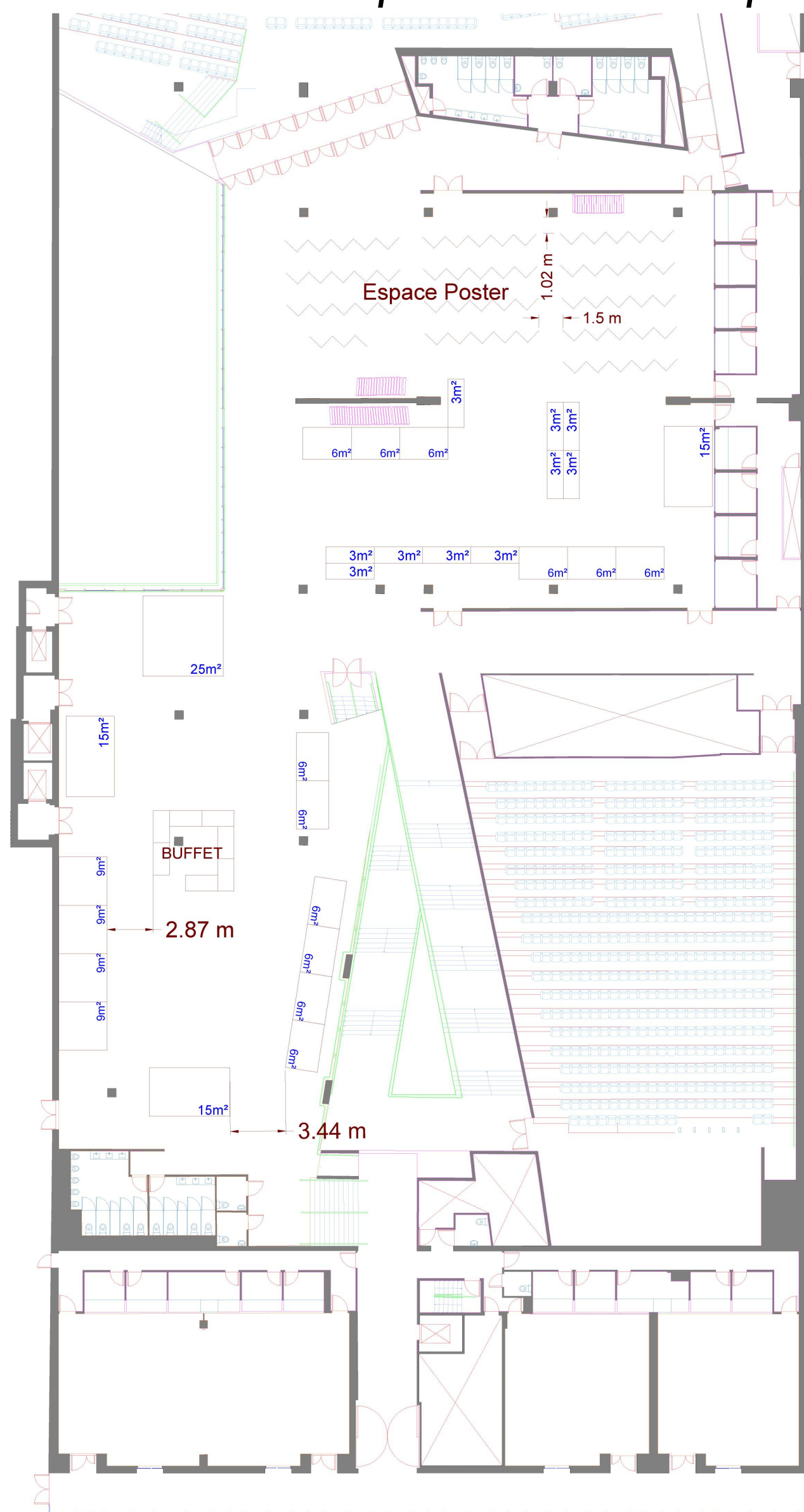

SMAP 2024

PRELIMINARY PROGRAM



SMAP
2024
Lille

| | | Lundi-16 | Mardi-17 | | Mercredi-18 | | Jeudi-19 | |
|-------|-------|--|-------------------------------|--------------------|-----------------------|--------------------|------------------------|---------------------|
| 08:00 | 08:15 | | Plenary N.2 | | Plenary N.4 | | Plenary N.6 | |
| 08:15 | 08:30 | | | | | | | |
| 08:30 | 08:45 | | | | | | | |
| 08:45 | 09:00 | | | | | | | |
| 09:00 | 09:15 | | Parallel session 1 | Parallel session 1 | Parallel session 5 | Parallel session 5 | Parallel session 9 | Parallel session 9 |
| 09:15 | 09:30 | | | | | | | |
| 09:30 | 09:45 | ateliers/réunions satellites/ club jeunes | Parallel session 2 | Parallel session 2 | Parallel session 6 | Parallel session 6 | Parallel session 10 | Parallel session 10 |
| 09:45 | 10:00 | | | | | | | |
| 10:00 | 10:15 | | | | | | | |
| 10:15 | 10:30 | | | | | | | |
| 10:30 | 10:45 | | Poster session / coffee break | | | | | |
| 10:45 | 11:00 | | | | | | | |
| 11:00 | 11:15 | | | | | | | |
| 11:15 | 11:30 | | | | | | | |
| 11:30 | 11:45 | Lunch | Constructors' session | Lunch | Constructors' session | Lunch | Constructors' session | |
| 11:45 | 12:00 | | | | | | | |
| 12:00 | 12:15 | | | | | | | |
| 12:15 | 12:30 | | | | | | | |
| 12:30 | 12:45 | | Parallel session 3 | Parallel session 3 | Parallel session 7 | Parallel session 7 | SFSM researcher Awards | |
| 12:45 | 13:00 | | | | | | | |
| 13:00 | 13:15 | | | | | | | |
| 13:15 | 13:30 | | | | | | | |
| 13:30 | 13:45 | | Poster session / coffee break | | | | FPS researcher Awards | |
| 13:45 | 14:00 | Registration | Parallel session 4 | Parallel session 4 | Parallel session 8 | Parallel session 8 | Plenary N.7 | |
| 14:00 | 14:15 | | | | | | Plenary N.7 | |
| 14:15 | 14:30 | | | | | | Plenary N.7 | |
| 14:30 | 14:45 | | | | | | Plenary N.7 | |
| 14:45 | 15:00 | welcome session | Poster session / coffee break | | | | FPS researcher Awards | |
| 15:00 | 15:15 | | Poster session / coffee break | | | | FPS researcher Awards | |
| 15:15 | 15:30 | | Poster session / coffee break | | | | FPS researcher Awards | |
| 15:30 | 15:45 | | Poster session / coffee break | | | | FPS researcher Awards | |
| 15:45 | 16:00 | SFSM thesis Awards | Parallel session 4 | Parallel session 4 | Parallel session 8 | Parallel session 8 | Plenary N.7 | |
| 16:00 | 16:15 | FPS thesis Awards | | | | | Plenary N.7 | |
| 16:15 | 16:30 | | | | | | Plenary N.7 | |
| 16:30 | 16:45 | | | | | | Plenary N.7 | |
| 16:45 | 17:00 | | closing session | | | | closing session | |
| 17:00 | 17:15 | Plenary N.1 | Plenary N.3 | | Plenary N.5 | | closing session | |
| 17:15 | 17:30 | | | | | | closing session | |
| 17:30 | 17:45 | | | | | | closing session | |
| 17:45 | 18:00 | | | | | | closing session | |
| 18:00 | 18:15 | Networking, affichage poster, stand master | AG SFSM/FPS | | Lille Activity | | closing session | |
| 18:15 | 18:30 | | AG SFSM/FPS | | | | closing session | |
| 18:30 | 18:45 | | AG SFSM/FPS | | | | closing session | |
| 18:45 | 19:00 | | AG SFSM/FPS | | | | closing session | |
| 19:00 | 19:15 | Cocktail | ECR Event | | Gala | | closing session | |
| 19:15 | 19:30 | | | | | | closing session | |
| 19:30 | 19:45 | | | | | | closing session | |
| 19:45 | 20:00 | | | | | | closing session | |
| 20:00 | 20:15 | | ECR Event | | Gala | | closing session | |
| 20:15 | 20:30 | | ECR Event | | Gala | | closing session | |
| 20:30 | 20:45 | | ECR Event | | Gala | | closing session | |
| 20:45 | 21:00 | | ECR Event | | Gala | | closing session | |
| 21:00 | 22:00 | | ECR Event | | Gala | | closing session | |



Lille offers the perfect blend of history, innovation, and accessibility, making it an ideal choice for our next SMAP event. Lille is located in the center of the department of Hauts-de-France, about 15km from the border between France and Belgium. With 236,234 habitants, among which more than 115 000 students, Lille is considered a young city.

Lille is also known in France as the "Capital of Flanders", in fact Lille its surroundings belong to the historical region of Romanesque Flanders. Today, Lille is the seat of art and gastronomy of the Hauts-de-France region. More than a charming heritage and welcoming inhabitants, Lille is full of cultural and culinary delights. Here's why you should consider your participation to Lille SMAP 2024:



A Rich Cultural Heritage: Lille boasts a captivating blend of old-world charm and modern dynamism. Its historic city center, with its stunning architecture, narrow cobblestone streets, and picturesque squares, provides a unique landscape to our conference. Delegates can immerse themselves in Lille's rich cultural heritage, from its magnificent Grand Place to the Palais des Beaux-Arts, one of France's largest fine arts museums.

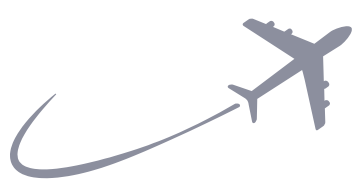

Accessibility: Located at the crossroads of Europe, Lille is incredibly accessible. Its central location makes it easy for attendees to reach from major European cities, including Paris, London, and Brussels. The city's modern transportation infrastructure, including the Eurostar and TGV train stations, ensures hassle-free travel for your participants.



Culinary Delights: Lille is renowned for its culinary delights. Delegates can savor exquisite French cuisine in local bistros, sample regional specialties like "carbonnade flamande" and "potjevleesch," and explore the bustling Wazemmes Market for fresh produce and international flavors. Lille's culinary scene adds a delectable dimension to your conference experience.!



Cultural Diversity: Lille is a melting pot of cultures, making it an inclusive and welcoming city for international participants. Our city's diversity enriches the conference experience and encourages networking and cross-cultural exchanges.

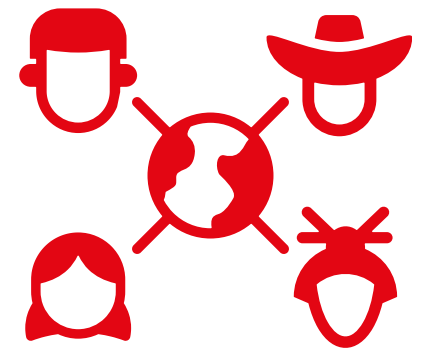

Vibrant Social Scene: Lille comes alive after hours. Participants can unwind in the city's vibrant bars, cafes, and clubs, fostering informal networking and building lasting connections.



In addition, In September Lille is one of the most visited cities thanks to **La Grande Braderie de Lille**. Every autumn, Lille becomes the largest antiques market in Europe: between one and two million visitors walk the streets of the city, accompanied by music and entertainment. Usually organized on the first weekend of September, in 2024 we will be lucky to have it organized on the weekend before congress on September 14-15, an exceptional opportunity to enjoy getting to know La Grande Braderie de Lille.

By choosing Lille for our conference, we provide to our participants an enriching professional experience but also an opportunity to discover a charming city with a unique blend of history and modernity. Join us in showcasing your brand and supporting a memorable conference in Lille - a city that inspires innovation and fosters collaboration.

**BECOME A SPONSOR AND BE PART OF AN UNFORGETTABLE
CONFERENCE EXPERIENCE IN THE HEART OF EUROPE!**

SMAP 2024

GENERAL TERMS AND CONDITIONS



SMAP
2024
Lille

The following general terms and conditions define the conditions for participation of a company as an exhibitor to SMAP 2024 Congress.

VAT applied : 20%

Request for participation and payment methods

Any company wishing to participate to SMAP 2024 have to register online (*coming soon*),
Transmission of this registration constitutes a firm commitment to pay the full price of the rental of the booth and / or different service options chosen by the exhibitor/sponsor.

The company "Insight Outside" is responsible for issuing and forwarding the invoice to the participating company. Payment is to be made upon receipt of the invoice.

Registration disclaimer - cancellation by the exhibitor

Application for participation constitutes a firm commitment.

- Cancellation notice received before 19 March, 2024 : 100% refund
- Cancellation notice received between 19 March, 2024 to 19 June, 2024: 50% refund
- Cancellation notice received from 19 June: no refund

Any withdrawal must be communicated by the exhibiting company by email at the following address: sponsors-smap2024@inviteo.fr

In the event that an exhibitor, for any reason, does not occupy his booth at the set-up time, it will be considered as resigning. The organizer may dispose of the booth of the defaulting exhibitor without the latter being able to claim any refund or compensation, even if the booth is allocated to another exhibitor.

If you have any question, any issue or any request, don't hesitate to contact us by mail at the following adress : sponsors-smap2024@inviteo.fr



SMAP
2024
Lille

CONTACT

Sponsors secretary

sponsors-smap2024@inviteo.fr

Sponsors and exhibition form

Coming soon !